

**INVITATION TO BID
ASBESTOS REMOVAL FROM REPLACEMENT OF EXTERIOR WINDOW
PROJECT
WAKEFIELD SCHOOL DISTRICT**

The SAU #101 Office is soliciting bids for **Asbestos Removal from Replacement of Exterior Window Project** for the WAKEFIELD SCHOOL DISTRICT. There will be a mandatory walkthrough on **March 20, 2020** at 10:00PM at the Paul School, 60 & 76 Taylor Way, Wakefield, NH 03872. Bid specifications can be obtained at the SAU #101 Office, the Paul School or the SAU #101 website: www.sau101.org. Bids are due by 2:00PM, April 3, 2020, and may be mailed or delivered to the SAU #101 Office, 76 Taylor Way, Sanbornville, N.H. 03872. Bids are to be sealed and clearly marked, "Asbestos Removal from Replacement of Exterior Window Project."

E-mail, fax or other forms of the proposal will not be accepted. Proposals received after the closing date and time will not be accepted.

REJECTION/AWARD OF PROPOSALS: The School District reserves the right to accept or reject any or all proposals, to negotiate with any or all Bidders, and to waive any informalities in the Request for Proposals process, and to enter into an agreement with the Bidder whom the School District in its sole discretion determines is in the best interests of the School District even though the Bidder may not submit the lowest bid or proposal. Bidders shall be responsible for any and all expenses that they may incur in preparing their proposals.

WITHDRAWAL OF ANY PROPOSALS is prohibited for a period of one-hundred eighty (180) days after the proposal due date.

STATE OF NEW HAMPSHIRE
SCHOOL ADMINISTRATIVE UNIT #101
WAKEFIELD SCHOOL DISTRICT

Owner: The School Board of Wakefield School District
Project: Asbestos Removal from Replacement of Exterior Window Project
Overview: Wakefield School District invites proposals for the Asbestos Removal from Replacement of Exterior Window Project

Project Contact: Joe Williams
Facilities Manager, SAU #101
60 Taylor Way
Sanbornville, NH 03872
603-630-2089

Due Date: Until 2:00 p.m. local time, on the 3rd day of April, the Wakefield School District will receive the original proposal as herein set forth in a sealed envelope marked "Asbestos Removal from Replacement of Exterior Window Project Wakefield School District RFP" at the office of:

School Administrative Unit #101
76 Taylor Way
Sanbornville, N.H. 03872

Attn.: Joe Williams

E-mail, fax, or other forms of the proposal will not be accepted. Proposals received after the closing date and time will not be accepted.

REJECTION/AWARD OF PROPOSALS: The School District reserves the right to accept or reject any or all proposals, to negotiate with any or all Bidders, and to waive any informalities in the Request for Proposals process, and to enter into an agreement with the Bidder whom the School District in its sole discretion determines is in the best interest of the School District even though the Bidder may not submit the lowest bid or proposal. Bidders shall be responsible for any and all expenses that they may incur in preparing their proposals.

WITHDRAWAL OF ANY PROPOSALS is prohibited for a period of one-hundred eighty (180) days after the proposal due date.

**STATE OF NEW HAMPSHIRE
SCHOOL ADMINISTRATIVE UNIT #101
WAKEFIELD SCHOOL DISTRICT**

All bidders must attend a mandatory pre-bid meeting on **March 20, 2020**, at 1:00 PM at the Paul School and are advised to inspect the job after that meeting.

I. GENERAL INFORMATION

1. Wakefield School District is soliciting proposals for the **Asbestos Removal from Replacement of Exterior Window Project** for Wakefield School District as needed for the Paul School located at 60 Taylor Way, Sanbornville, NH 03872.
2. The School District intends to enter into an agreement effective **April of 2020** for this project. The selection of the Bidder is conditioned upon the successful Bidder signing a contract agreeable to the School District. If the successful Bidder does not sign the contract, the School District may withdraw its offer and select another Bidder.
3. The School District prefers to maintain only one (1) contact person throughout the proposal process. Please appoint one (1) representative of your company with the responsibility for communicating with the School District on all matters relative to this Request for Proposal. During this process, all communications must be channeled through the Facilities Manager to ensure proper documentation and dissemination of information.
4. **The Form of Proposal and the signature page must be completed in its entirety; failure to do so may render your proposal incomplete and subject to disqualification. All information available regarding this bid is contained within this RFP.**
5. The items specified on the Attachments "A" in this RFP are intended to provide a foundation for a contractual agreement. Your bid should include items, which, in your professional opinion, are needed for the Asbestos Removal from Replacement of Exterior Window Project WSD RFP. Deviations from the established format may result in disqualification of proposal. Your proposal must clearly indicate any deviations.

II. TERMS AND CONDITIONS

1. Wakefield School District reserves the right to solicit additional information from Bidders to determine which Bidder best meets the needs of the School District. Additional information may include (but is not limited to) past performance records; list of available personnel, plant and equipment; description of work which will be done

**STATE OF NEW HAMPSHIRE
SCHOOL ADMINISTRATIVE UNIT #101
WAKEFIELD SCHOOL DISTRICT**

simultaneously with the School District project; financial statements; on-site tour and evaluation by School District personnel; references, or any other pertinent information. The Wakefield School District also reserves the right to investigate any and all Bidders to determine the Bidder's ability to perform services under the RFP.

2. Successful Bidder agrees to maintain comprehensive general liability insurance, including contractual liability, with limits not less than \$1 million per occurrence and \$2 million aggregate; professional liability with limits not less than \$1 million per occurrence and \$2 million aggregate; automobile liability for owned, non-owned and hired vehicles with a combined single limit not less than \$1 million per occurrence; Employers Liability with a minimum limit of \$500,000; and Workers' Compensation to statutory limits as required by the State of New Hampshire. Successful Bidder agrees to have the Wakefield School District added as an additional insured with respect to comprehensive general liability insurance and provide the School District with 30 days prior written notice of any material changes in the above insurance. Successful Bidder shall provide the School District with a certificate of the above insurance coverage and amounts upon execution of this agreement.
3. Successful Bidder shall indemnify the School District, its school board members, officers, employees, agents and students from and against any costs, losses, damages, liabilities, expenses, demands and judgments, including court costs and attorney fees, which may arise out of Bidder's performance of services, except to the extent caused by the sole fault or negligence of the School District.
4. The School District may at any time terminate the services and/or Contract with the successful Bidder at the School District's convenience and without cause. In case of termination for the School District's convenience, the successful Bidder shall be entitled to receive payment from the School District limited to actual documented expenses as of the date of termination as its sole remedy. In no event will the School District be responsible for lost profits, compensatory or other consequential damages.

**STATE OF NEW HAMPSHIRE
SCHOOL ADMINISTRATIVE UNIT #101
WAKEFIELD SCHOOL DISTRICT**

III. FORM OF PROPOSAL

All responses to this RFP shall consist of the signature page as a cover sheet, Attachment "A", and the responses to the following information, which must be numbered exactly as listed. The following requirements constitute the minimum for all bids. Failure to do so may render your proposal incomplete and subject to disqualification.

1. Provide general information about your company including financial statements or annual reports. Brief description of company structure, ownership, and parent company information.
2. Provide explanation and list of your company's services.
3. How long has your company been in business?
4. Provide a list of similar projects from your company. (This list can be returned upon request.)
5. Submit a minimum of three (3) references of projects of similar size; which is preferred or larger. Please include the contact name, organization, address, phone/fax numbers, and the date of the project.
6. Use the attached spreadsheet and/or list and/or diagrams, called Attachment "A through E" to document the total price to provide the services. All proposals pricing should include all time, materials, labor, shipping, etc. Any fees/charges not identified at this point will NOT be allowed for the term of the contract period. Prices will be firm for six (6) months.

**STATE OF NEW HAMPSHIRE
SCHOOL ADMINISTRATIVE UNIT #101
WAKEFIELD SCHOOL DISTRICT**

**Wakefield School District
Business Office
76 Taylor Way
Sanbornville, N.H. 03872**

PROJECT NAME: Asbestos Removal from Replacement Exterior Window Project

DUE DATE: April 3, 2020

**Contact: Joe Williams
Phone: (603) 630-2089**

ISSUED: MARCH 11, 2020

ALL PAGES OF THIS DOCUMENT MUST BE RETURNED TO ENSURE A VALID BID. BIDS SUBMITTED WITHOUT ALL PAGES CAN BE RENDERED INVALID. SEND ALL CORRESPONDENCE, AND REFERENCE PROJECT NAME, TO THE ADDRESS SHOWN ABOVE ON THE LEFT. WAKEFIELD SCHOOL DISTRICT STANDARD TERMS AND CONDITIONS SHALL APPLY.

**Asbestos Removal from Replacement Exterior Window Project
Wakefield School District**

Please complete the following:

Terms Net 30 **E.I.N.** _____ **D & B No.** _____

Company Name _____

Signature _____

Printed Name _____ **Title** _____

Phone # _____ **Fax #** _____

Bid Items: Cost to accomplish the Work as described within the specification.

Maximum price \$ _____

F.O.B. POINT: PRICES QUOTED SHALL BE FOB WAKEFIELD SCHOOL DISTRICT UNLESS OTHERWISE SPECIFIED.
COMPLIANCE: VENDOR MUST COMPLY WITH PROVISIONS OF STATE AND FEDERAL OSHA LAWS, STANDARDS, AND REGULATIONS.
ACCEPTANCE: PLEASE ITEMIZE ALL PRICES, DISCOUNTS AND CHARGES. WE RESERVE THE RIGHT TO ACCEPT ALL OR PART, OR DECLINE THE WHOLE. THERE IS NO OBLIGATION TO BUY.
TAXES: NONE
SPECIFICATIONS: ATTACH COMPLETE SPECIFICATIONS FOR ANY SUBSTITUTION OFFERED.

**STATE OF NEW HAMPSHIRE
SCHOOL ADMINISTRATIVE UNIT #101
WAKEFIELD SCHOOL DISTRICT**

**ASBESTOS REMOVAL FROM REPLACEMENT EXTERIOR WINDOW PROJECT
ATTACHMENT "A "
WAKEFIELD SCHOOL DISTRICT**

Asbestos Removal from Replacement from Exterior Window Project

ATTACHMENT "A"

- All work to remove asbestos must be completed before installation of new windows.
- Protocol must be followed for proper dismantling, storage, and disposal of all hazardous material.
- Employees of contracted company must have certified credentials for the removal, storage, and disposal of hazardous material.
- Contract that has been awarded bid must work with contracted window company to complete asbestos removal in order to keep timeline of project on time.
- Contractor must follow documentation from Scott Lawson Group Ltd. For specific areas that need to be addressed for asbestos removal. See Attached.
- Contractor that is awarded bid must start directly after the school year has ended tentatively June of 2020.
- Construction site inside and out must be clean of debris and secure daily at the workdays end.
- All proper equipment for ventilation and safety for the employees, Wakefield School District staff, and any other persons involved at the property located at 60 and 76 Taylor Way.
- See attached section of building and results of asbestos used in the caulking.

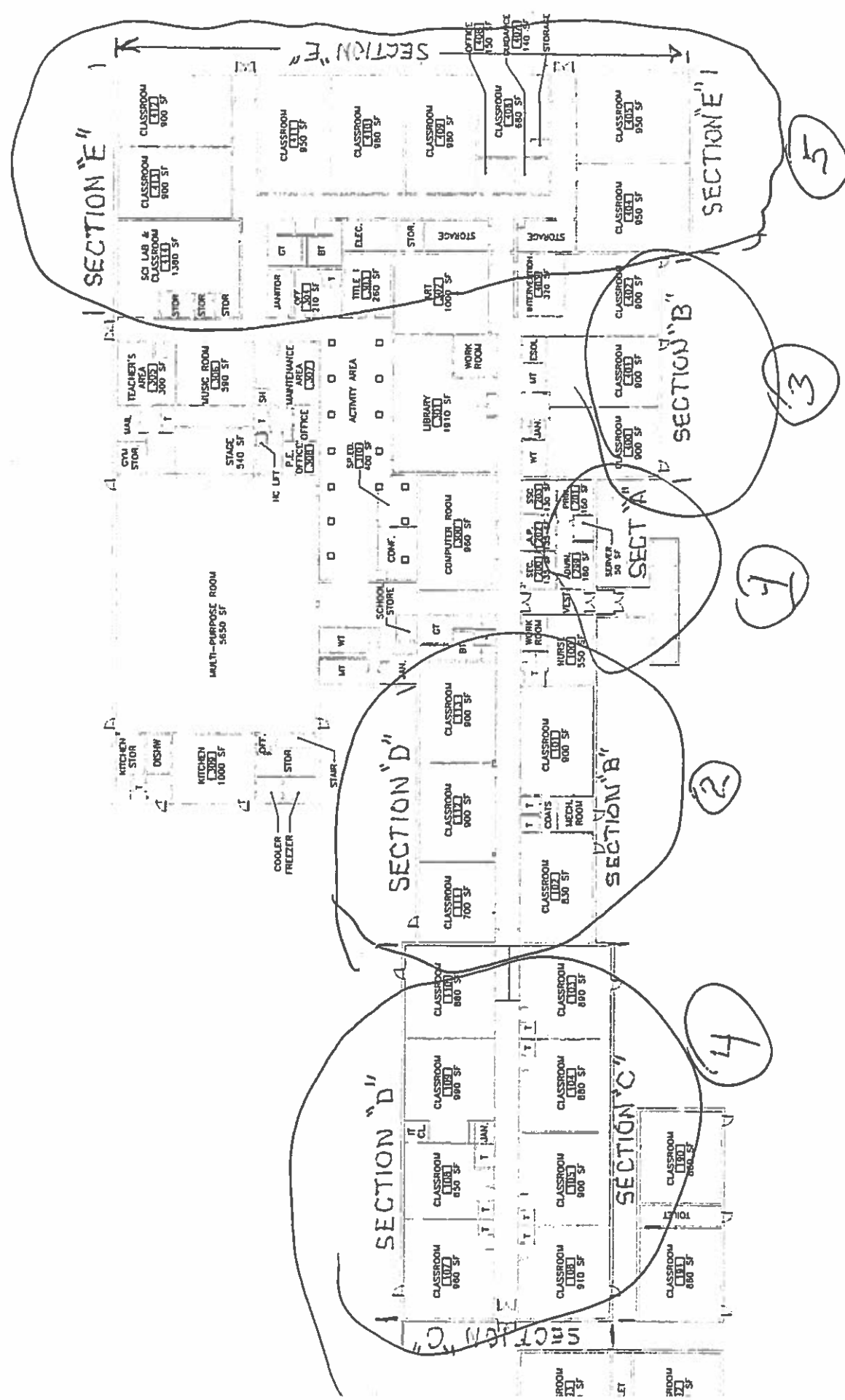

Paul School – Window Section Plan



The Scott Lawson Group, Ltd.

Environmental, Health & Safety Consultants
20 Chenell Drive, Concord, NH 03301
(800) 645-7674 ♦ FAX (603) 228-3871

14 Milion & Wakefield School Districts
Commerce Way, Unit 1
Concord, NH 03851

SCGZ Job #: 14-3143
Report Date: July 30, 2014
Date Sampled: July 25, 2014
Date Received: July 28, 2014
Client Project: Paul School
Window replacement

Analysis: Asbestos by Polarized Light Microscopy

Methodology: EPA-600/M4-82-020 / 600/R-93/16 July 1993

Analytical Results

Collected by: SRM

#	Sample Identification	Obvious		Asbestos %				Fibrous			Date Analyzed	Analyst	
		Homogeneous	Layers	Fibrous	Color	Chrysotile	Amosite	Crocidolite	Glass	Other			Material
072514-3143-B01	Black window caulking, section B&D, int. room 102, perimeter of window	No	Yes	Yes	Black	ND	ND	ND	ND	ND	100	07/29/2014	NEF
072514-3143-B02	Black window caulking, section C&D, int. room 103, perimeter of window	No	Yes	Yes	Brown	ND	ND	ND	ND	ND	100	07/29/2014	NEF
072514-3143-B03	Clear window caulking, section C&D, int. room 104, perimeter of window	No	Yes	No	Clear	ND	ND	ND	ND	ND	100	07/29/2014	NEF
072514-3143-B04	Dark brown window caulking, section C&D, int. room 106, perimeter of window	No	No	No	Brown	ND	ND	ND	ND	ND	100	07/29/2014	NEF
072514-3143-B05	White window caulking, section C&D, int. room 107, perimeter of window	No	Yes	No	White	ND	ND	ND	ND	ND	100	07/29/2014	NEF
072514-3143-B06	Brown window caulking, section B&D, int. room 111, perimeter of window	No	Yes	Yes	Brown	ND	ND	ND	ND	ND	100	07/29/2014	NEF

Polarized Light Microscopy report relates only to items tested. Client should not use the NVLAP to determine PLM by visual area estimation can produce errors of 10%. Results near the 1% level should be more accurately quantified by the point count method or Transmission Electron Microscopy. Laboratory certifications apply only to samples analyzed in-house.

Lab Code 101228-0.

Reviewed By: Helen M. Enzer
Approved By: Norman Fletcher
Norman Fletcher, Lab Manager



The Scott Lawson Group, Ltd.

Environmental, Health & Safety Consultants
20 Chenell Drive, Concord, NH 03301
(800) 645-7674 ♦ FAX (603) 228-3871

64 Milton & Wakefield School Districts
Commerce Way, Unit 1
Concord, NH 03851

SLG Job #: 14-3143
Report Date: July 30, 2014
Date Sampled: July 25, 2014
Date Received: July 28, 2014
Client Project: Paul School
Window replacement

Analysis: Asbestos by Polarized Light Microscopy

Methodology: EPA-600/M4-82-020 / 600/R-93/116 July 1993

Analytical Results

Collected by: SRM

Lab #	Sample Identification	Homogeneous Layers	Obvious Layers	Fibrous	Color	Asbestos %				Other Fibrous Material %			Date Analyzed	Analyst	
						Chrysotile	Amosite	Crocidolite	Glass	Fibrous	Cellulose	Synthetic			Other
072514-3143-B07	Brown window caulking, section A, int. room 401, perimeter of window	No	No	No	Brown	ND	ND	ND	ND	ND	ND	ND	100	07/29/2014	NEF
072514-3143-B08	Brown window caulking, section E, int. room 402, perimeter of window	No	Yes	No	Brown White	ND	ND	ND	ND	ND	ND	ND	100	07/29/2014	NEF
072514-3143-B09	Brown window caulking, section E, int. room 406, perimeter of window	No	No	No	Brown	ND	ND	ND	ND	ND	ND	ND	100	07/29/2014	NEF
072514-3143-B10	Brown window caulking, section E, int. room 414, perimeter of window	No	Yes	No	Brown	ND	ND	ND	ND	ND	ND	ND	100	07/29/2014	NEF
072514-3143-B11	Brown window caulking, section E, ext. room 414, perimeter of window	No	No	No	Brown	ND	ND	ND	ND	ND	ND	ND	100	07/29/2014	NEF
072514-3143-B12	Li. brown window caulking, section E, ext. room 406, perimeter of window	No	No	No	Gray	ND	ND	ND	ND	ND	ND	ND	100	07/29/2014	NEF

Polarized Light Microscopy report relates only to items tested. Client should not use the NVLAP to determine. PLM by visual area estimation can produce errors of 10%. Results near the 1% are more accurately quantified by the point count method or Transmission Electron Microscopy. Laboratory certifications apply only to samples analyzed in-house.
Lab Code 101228-0.

Less than one detected sample analyzed as a composite. Sample analyzed as a composite; could not separate layers. Sample reported as a composite; layers analyzed separately. Test 'it' positive, not analyzed

Reviewed By: Helen H. Erzen

Approved By: Norman E. Fletcher

Norman Fletcher, Lab Manager



The Scott Lawson Group, Ltd.

Environmental, Health & Safety Consultants
20 Chenell Drive, Concord, NH 03301
(800) 645-7674 ♦ FAX (603) 228-3871

64 Milton & Wakefield School Districts
Commerce Way, Unit 1
n, NH 03851

SYGZ Job #: 14-3143
Report Date: July 30, 2014
Date Sampled: July 25, 2014
Date Received: July 28, 2014
Client Project: Prout School
Window replacement

Analysis: Asbestos by Polarized Light Microscopy

Methodology: EPA-600/M4-82-020 / 600/R-93/116 July 1993

Analytical Results

Collected by: SRM

Lab #	Sample Identification	Homogeneous	Obvious Layers	Fibrous	Color	Asbestos %			Other Fibrous Material %			Date Analyzed	Analyst	
						Chrysotile	Amosite	Crocidolite	Glass	Synthetic	Other			Fibrous Material
072514-3143-B13	Gray window caulking, section E, ext. room 401, perimeter of window	No	No	No	Gry	ND	ND	ND	ND	ND	ND	100	07/29/2014	NEF
072514-3143-B14	Brown window caulking, section E, ext. room 401, perimeter of window	No	No	No	Brown	ND	ND	ND	ND	ND	ND	100	07/29/2014	NEF
072514-3143-B15	Window glazing, section B&D, ext. room 102	No	No	No	Black	ND	ND	ND	ND	ND	ND	100	07/29/2014	NEF
072514-3143-B16	Dk. brown window caulking, section B&D, ext. room 102, perimeter of window	No	No	No	Brown	ND	ND	ND	ND	ND	ND	100	07/29/2014	NEF
072514-3143-B17	Window glazing, section A, ext. room 201	No	Yes	Yes	Beige Black	3	ND	ND	ND	ND	ND	97	07/29/2014	NEF
072514-3143-B18	Window glazing, section C&D, ext. room 103	No	No	No	Black	ND	ND	ND	ND	ND	ND	100	07/29/2014	NEF

arized Light Microscopy report relates only to items tested. Client should not use the NVLAP to
endorsement. PLM by visual area estimation can produce errors of 10%. Results near the 1%
may be more accurately quantified by the point count method or Transmission Electron Microscopy.
Laboratory certifications apply only to samples analyzed in-house.
Lab Code 101228-0.

ess than.
one Detected
sample analyzed as a composite.
sample analyzed as a composite; could not separate layers.
sample reported as a composite; layers analyzed separately.
est 'til positive, not analyzed

Reviewed By: Heleen H. Erzen
Approved By: Norman E. Fletcher
Norman Fletcher, Lab Manager



The Scott Lawson Group, Ltd.

Environmental, Health & Safety Consultants
20 Chenell Drive, Concord, NH 03301
(800) 645-7674 ♦ FAX (603) 228-3871

164 Milton & Wakefield School Districts
Commerce Way, Unit 1
Concord, NH 03301

SZGL Job #: 14-3143
Report Date: July 30, 2014
Date Sampled: July 25, 2014
Date Received: July 28, 2014
Client Project: Paul School
Window replacement

Analysis: Asbestos by Polarized Light Microscopy
Methodology: EPA-600/M14-82-020 / 600/R-93/116 July 1993

Collected by: SRM

Analytical Results

Lab #	Sample Identification	Homogeneous	Obvious Layers	Fibrous	Color	Chrysotile	Amosite	Crocidolite	Asbestos %			Fibrous Material	Date Analyzed	Analyst
									Fibrous	Synthetic	Other			
1	072514-3143-B19, Brown window caulking, section C&D, ext. room 103, perimeter of window	No	No	No	Brown	ND	ND	ND	ND	ND	ND	100	07/29/2014	NEF
1	072514-3143-B20, Lt. brown window caulking, top layer, section C&D, ext. room 107, perimeter of window	No	No	No	Brown	ND	ND	ND	ND	ND	ND	100	07/29/2014	NEF
5	072514-3143-B21, Dk. brown window caulking, bottom layer, section C&D, ext. room 107, perimeter of window	No	No	No	Brown	ND	ND	ND	ND	ND	ND	100	07/29/2014	NEF
5	072514-3143-B22, Gray window caulking, top layer, section C&D, ext. room 110, perimeter of window	No	No	No	Gray	ND	ND	ND	ND	ND	ND	100	07/29/2014	NEF
7	072514-3143-B23, Brown window caulking, bottom layer, section C&D, ext. room 110, perimeter of window	No	No	No	Brown	ND	ND	ND	ND	ND	ND	100	07/29/2014	NEF
8	072514-3143-B24, Window glazing, section B&D, ext. room 110, perimeter of window	No	No	Yes	Black	5	ND	ND	ND	ND	ND	95	07/29/2014	NEF



Polarized Light Microscopy report relates only to items tested. Client should not use the NVLAP to endorsement. PLM by visual area estimation can produce errors of 10%. Results near the 1% can be more accurately quantified by the point count method or Transmission Electron Microscopy. Laboratory certifications apply only to samples analyzed in-house.
AP Lab Code 101228-0.

- : Less than.
- : None Detected
- : Sample analyzed as a composite.
- : Sample reported as a composite; could not separate layers.
- : Sample reported as a composite; layers analyzed separately.
- : Test 'H' positive, not analyzed

Reviewed By: Helmut H. Enzer
Approved By: Norman S. Jable
Norman Fletcher, Lab Manager



The Scott Lawson Group, Ltd.

Environmental, Health & Safety Consultants
20 Chencill Drive, Concord, NH 03301
(800) 645-7674 ♦ FAX (603) 228-3871

64 Milton & Wakefield School Districts
Commerce Way, Unit 1
Con, NH 03851

SLGZ Job #: 14-3143
Report Date: July 30, 2014
Date Sampled: July 25, 2014
Date Received: July 28, 2014
Client Project: Paul School
Window replacement

Analysis: Asbestos by Polarized Light Microscopy
Methodology: EPA-600/M4-82-020 / 600/R-93/116 July 1993

Collected by: SRM

Analytical Results

Lab #	Sample Identification	Homogeneous	Obvious Layers	Fibrous	Color	Asbestos %			Fibrous Material			Date Analyzed	Analyst	
						Chrysotile	Amosite	Crocidolite	Glass	Cellulose	Synthetic			Other
072514-3143-B25	Brown window caulking, section B&D, ext room 111, perimeter of window	No	Yes	Yes	Black	8	ND	ND	ND	ND	ND	92	07/29/2014	NEF

Polarized Light Microscopy report relates only to items tested. Client should not use the NVLAP to endorsement. PLM by visual area estimation can produce errors of 10%. Results near the 1% can be more accurately quantified by the point count method or Transmission Electron Microscopy. Laboratory certifications apply only to samples analyzed in-house.
P Lab Code 101228-0.

Less than.
None Detected
Sample analyzed as a composite.
Sample analyzed as a composite; could not separate layers.
Sample reported as a composite; layers analyzed separately.
Test 'ijl' positive, not analyzed

Reviewed By:

Helen H. Entzer

Approved By:

Norman E. Fletcher

Norman Fletcher, Lab Manager



The Scott Lawson Group, Ltd.
Environmental, Health & Safety Consultant

20 Chenell Drive
Concord, New Hampshire 03301
Ph: (603) 228-3610, Fax: (603) 228-3871
www.slg.com email: Lab@slg.com

Submitting Co.: SAU 64

Address:

Client Project: PAU School

Client PO: Window Replacement

SLGL Job #:
Sampled By: SMC
email:

Attention:
Phone:
Fax:

Turnaround Time (select one)
 1-3 hours* 1-6-8 hours* 1-24 hours* 1-48 hours* 1-72 hours*
 5 days 1-10 days 1-Weekend Other: _____

Sample Matrix Type (select one)
 Air Bulk Soil Water, drinking or waste
 Aqueous Oil Solid Wipe
 Agar (biostrip) Paint Swab Wipe composite
 Agar (plate) Sludge Tape Lift Other: _____

Comments:
 Samples received in good condition? Yes No

SLGL Lab #	Sample Identification	Analysis	Date Sampled	Time	Media/ Container	Preservative	4°C	Swab/Wipe Area Units:	Air Volume (L)	Minutes
31555	072514-3143-601	PCM	7/25	-	Bag				N/A	N/A
350	602									
351	603									
352	604									
353	605									
360	606									
361	607									
362	608									
363	609									
364	610									

Requested By:
 Date/Time: 7/28/14 0800
 Received By: Helen McEwen
 Date/Time: 7/28/14 1045
 Samples Shipped Via: FedEx UPS DHL US Mail Drop Box Drop OIT Other
 Requisition #: _____
 Date/Time: _____

A Note to Customer: by signing and relinquishing your samples to the laboratory, you agree with the terms and conditions found on the back of this Chain of Custody Form.



The Scott Lawson Group, Ltd.
Environmental, Health & Safety Consultants

20 Chenell Drive
Concord, New Hampshire 03301
Ph: (603) 228-3610, Fax: (603) 228-3871
www.slg.com email: Lab@slg.com

Submitting Co.: **SAU 64**

Address:

Client Project: **PAUL School**

Client PO:

Sampled By:

email:

Attention:

Phone:

Fax:

Comments:

Turnaround Time (select one)
 13 hours* 24 hours* 48 hours* 72 hours*
 5 days 10 days Weekend Other: _____

Not available for all tests. Schedule rush and weekend tests in advance.

Sample Matrix Type (select one)
 Air Bulk Soil
 Aqueous Oil Solid
 Agar (bioamp) Paint Swab
 Agar (plate) Sludge Tape Lift

All samples on this form should be of the SAME matrix type. Use additional forms as needed.

SLG Lab #	Sample Identification	Analysis	Date Sampled	Time	Media/ Container	Preservative	4°C	Swab/Wipe Area Units:	Air Volume (L)	Minutes
315305	072514-3143 - B11	PCR	7/25	N/A	bag				N/A	N/A
315306	B12									
315307	B13									
315308	B14									
315309	B15									
315310	B16									
315311	B17									
315312	B18									
315313	B19									
315314	B20									

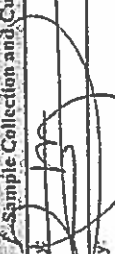
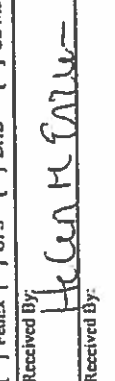
Samples Shipped Via: FedEx UPS DHL US Mail Drop Box Drop Off Other
 Relinquished By:  Date/Time: 7/25/14 0500
 Relinquished By:  Date/Time: 7/28/14 1045

A Note to Customer: by signing and relinquishing your samples to the laboratory, you agree with the terms and conditions found on the back of this Chain of Custody Form.



The Scott Lawson Group, Ltd.
Environmental, Health, & Safety Consultants

20 Chenell Drive
Concord, New Hampshire 03301
Ph: (603) 228-3610, Fax: (603) 228-3871
www.slg.com email: Lab@slg.com

Submitting Co.: **STU 64**

SLGL Job # **14-3193**

Client Project: **Pratt School**

Client PO: **Window Replacement**

Turnaround Time (select one)

3 hours* 6-8 hours* 24 hours* 48 hours* 72 hours*
 10 days 10 days Weekend Other: _____

Sampled By: **SM**

email:

Phone: _____

Fax: _____

Sample Matrix Type (select one)

Air Dusk Soil
 Aqueous Oil Solid
 Agar (biostrip) Paint Swab
 Agar (plate) Sludge Tapo Lift

Comments:

Water, drinking or waste
 Wipe
 Wipe composite
 Other: _____

Preservative

Media/Container

Time

Date Sampled

Analysis

Sample Identification

SEGL Lab #

Swab/Wipe Area Units:

Air Volume (L)

4°C

Minutes

Samples received in good condition: Yes No

Use additional forms as needed.

Swab/Wipe Area Units:

Air Volume (L)

4°C

Minutes

Samples received in good condition: Yes No

Use additional forms as needed.

Swab/Wipe Area Units:

Air Volume (L)

4°C

Minutes

Samples received in good condition: Yes No

Use additional forms as needed.

Swab/Wipe Area Units:

Air Volume (L)

4°C

Minutes

Samples received in good condition: Yes No

Use additional forms as needed.

Swab/Wipe Area Units:

Air Volume (L)

4°C

Minutes

Samples received in good condition: Yes No

Use additional forms as needed.

Swab/Wipe Area Units:

Air Volume (L)

4°C

Minutes

Samples received in good condition: Yes No

Use additional forms as needed.

Sample Collection and Custody Information

Samples Shipped Via: FedEx UPS DHL US Mail Drop Box Drop Off Other

Date/Time: **7/28/14 10:45**

Received By: **HELEN K. ELLER**

Date/Time: _____

Received By: _____

Date/Time: _____

Received By: _____

Date/Time: _____

A Note to Customer: by signing and relinquishing your samples to the laboratory, you agree with the terms and conditions found on the back of this Chain of Custody Form.



The Scott Lawson Group, Ltd.
Environmental, Health & Safety Consultants

BULK SAMPLE DATA FORM

CLIENT: SAU 64	DATE: 7-25-14
PROJECT: Window Replacement Project-Paul School	JOB NUMBER: 14-3143

SAMPLE NUMBER	MATERIAL DESCRIPTION	SAMPLE LOCATION
072514-3143-B01	Black Window Caulking	Section B&D, Int. Room 102, Perimeter of Window
072514-3143-B02	Black Window Caulking	Section C&D, Int. Room 103, Perimeter of Window
072514-3143-B03	Clear Window Caulking	Section C&D, Int. Room 104, Perimeter of Window
072514-3143-B04	Dark Brown Window Caulking	Section C&D, Int. Room 106, Perimeter of Window
072514-3143-B05	White Window Caulking	Section C&D, Int. Room 107, Perimeter of Window
072514-3143-B06	Brown Window Caulking	Section B&D, Int. Room 111, Perimeter of Window
072514-3143-B07	Brown Window Caulking	Section A, Int. Room 401, Perimeter of Window
072514-3143-B08	Brown Window Caulking	Section E, Int. Room 402, Perimeter of Window
072514-3143-B09	Brown Window Caulking	Section E, Int. Room 406, Perimeter of Window
072514-3143-B10	Brown Window Caulking	Section E, Int. Room 414, Perimeter of Window

NOTES:
Interior Caulking



The Scott Lawson Group, Ltd.
Environmental, Health & Safety Consultants

BULK SAMPLE DATA FORM

CLIENT: SAU 64	DATE: 7-25-14
PROJECT: Window Replacement Project-Paul School	JOB NUMBER: 14-3143

SAMPLE NUMBER	MATERIAL DESCRIPTION	SAMPLE LOCATION
072514-3143-B11	Brown Window Caulking	Section E, Ext. Room 414, Perimeter of Window
072514-3143-B12	Lt. Brown Window Caulking	Section E, Ext. Room 406, Perimeter of Window
072514-3143-B13	Gray Window Caulking	Section E, Ext. Room 401, Perimeter of Window
072514-3143-B14	Brown Window Caulking	Section E, Ext. Room 401, Perimeter of Window
072514-3143-B15	Window Glazing	Section B&D, Ext. Room 102
072514-3143-B16	Dk. Brown Window Caulking	Section B&D, Ext. Room 102, Perimeter of Window
* 072514-3143-B17	Window Glazing	Section A, Ext. Room 201
072514-3143-B18	Window Glazing	Section C&D, Ext. Room 103
072514-3143-B19	Brown Window Caulking	Section C&D, Ext. Room 103, Perimeter of Window
072514-3143-B20	Lt. Brown Window Caulking Top Layer	Section C&D, Ext. Room 107, Perimeter of Window
072514-3143-B21	Dk. Brown Window Caulking Bottom Layer	Section C&D, Ext. Room 107, Perimeter of Window
072514-3143-B22	Gray Window Caulking Top Layer	Section C&D, Ext. Room 110, Perimeter of Window
072514-3143-B23	Brown Window Caulking Bottom Layer	Section C&D, Ext. Room 110, Perimeter of Window
* 072514-3143-B24	Window Glazing	Section B&D, Ext. Room 111
* 072514-3143-B25	Brown Window Caulking	Section B&D, Ext. Room 111, Perimeter of Window